

- BEBAN PLAZA -
2220 BOWEN RD.

(Upper Level)

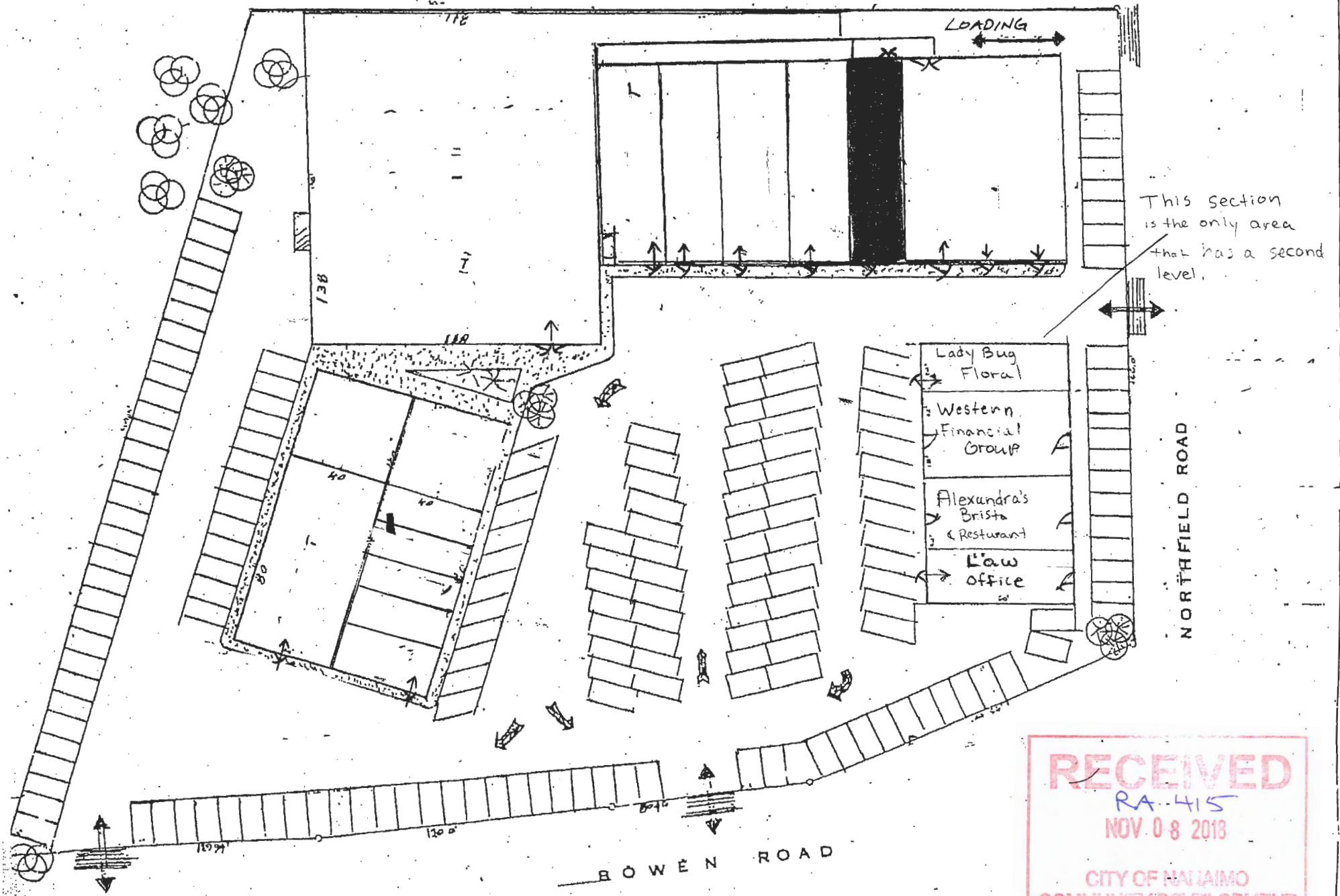

This section is the only area that has a second level.

RECEIVED
RA-415
NOV 08 2018
CITY OF NAJAIMO
COMMUNITY DEVELOPMENT

Island Cannabis Company LTD

- BEBAN PLAZA -
2220 BOWEN RD.

(Lower Level)

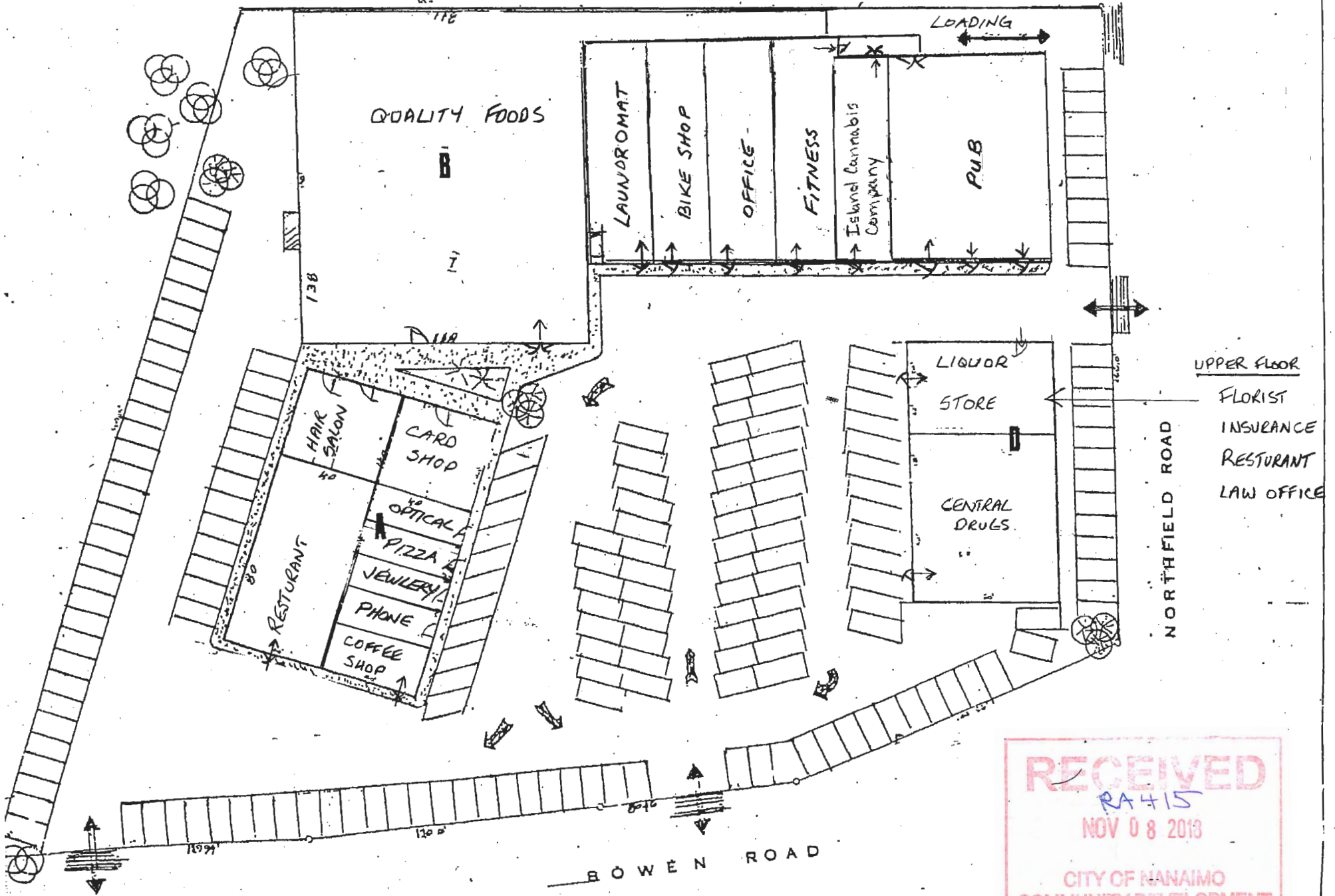

UPPER FLOOR
FLORIST
INSURANCE
RESTURANT
LAW OFFICE

RECEIVED
RA 415
NOV 08 2013
CITY OF NANAIMO
COMMUNITY DEVELOPMENT

Island Cannabis Company LTD